

PONANT Explorer Ships

*Le Bellot, Le Bougainville,
Le Champlain, Le Dumont-d'Urville,
Le Jacques-Cartier, Le Lapérouse*





Go beyond *green*

PONANT's ships are not only among the newest, most elegant, and most comfortable small vessels in the world today, they are also the most eco-friendly, having obtained the international "Clean Ships" (Bureau Veritas) certification for innovative green equipment. We are able to offer environmentally sound tourism in some of the world's most unspoiled regions utilizing our state-of-the-art systems and processes:

- A silent electric propulsion system cuts carbon emissions by 40%
- A sophisticated GPS system, called Dynamic Position, allows our ships to hover in a fixed location without anchor
- Conserve, filter, treat, and recycle all water used
- Treat wastewater with advanced filtration systems
- Sort, compact, and store all waste on board for recycling ashore
- Reduce electrical power by up to 90% with CFR and LED lighting
- Maintain a respectful distance from marine animals and ocean floor via advanced sonar 3-D imagery

Luxury small ships

The PONANT Explorer Yachts travel to the world's most inaccessible locations, sailing where others do not. With 100% balcony staterooms, they measure 430 feet in length and are designed for just 180 guests and 110 crew members. They feature innovative equipment, elegantly designed guest accommodations, and welcoming lounge areas that open to the outside. And, in a world exclusive, the PONANT Explorer yachts are the first ever to be equipped with an underwater, multi-sensory lounge, the Blue Eye. Located within the hull and 8 feet beneath the water line, the Blue Eye Lounge features two large underwater windows. In this serene space, guests also hear and sense nearby marine life through unique wave technology.



The PONANT Explorers series is designed to enable you to experience an expedition in a different way. Equipped with the **underwater Blue Eye lounge** and the latest technologies to limit environmental impact, our PONANT Explorer ships embody a refined atmosphere conducive to relaxation. They are designed to enable exploration from a place of luxurious tranquility.



1. The Blue Eye, multi-sensory underwater lounge
2. The Spa, in partnership with Sothys
3. The pool deck and its solarium
4. The panoramic restaurant, open to the outside
5. The theatre, where conferences, shows and performances take place



Public Areas

Reception

- Reception/concierge desk, excursions desk, ship's administrative services, sales office, boutique

Main Lounge

- Accommodates all of our guests to share convivial moments and host organized activities

Restaurants

Grill Restaurant

- Capacity: 70
- Buffet

Panoramic Restaurant

- Capacity: all guests
- Buffet and table service opens onto the outer deck

Recreation/Relaxation

Hydraulic Platform

- Easier boarding
- Easier Zodiac embarkation and disembarkation
- Easier access to the sea and practicing various water sports such as kayaking or paddle-boarding.

Pool Deck

- Pool with a panoramic view equipped with a counter-current swimming system, Solarium, Outdoor bar and lounge

Theater

- Capacity: 188
- Main show room for conferences and live entertainment on selected evenings
- State-of-the-art audio and video technology



PONANT Explorers Accommodations

OWNER'S SUITE

45 sq.m. + 30 sq.m. private terrace with hot tub and sliding bay windows
484 sq.ft. + 328 sq.ft. private terrace with hot tub and sliding bay windows



3 GRAND DELUXE SUITES

45 sq.m. + 30 sq.m. private terrace and sliding bay windows
484 sq.ft. + 328 sq.ft. private terrace and sliding bay windows

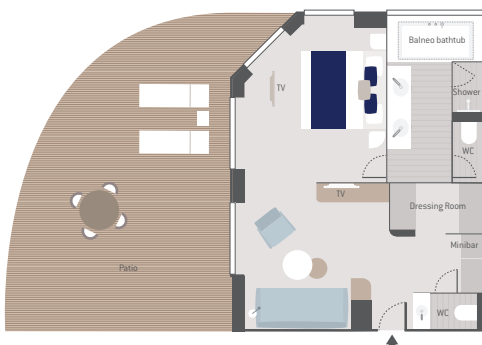

4 PRIVILEGE SUITES

32 sq.m. + 8 sq.m. private balcony with sliding bay window
344 sq.ft. + 86 sq.ft. private balcony with sliding bay window



18 PRESTIGE SUITES

38 sq.m. + 8 sq.m. private balcony with sliding bay window
409 sq.ft. + 86 sq.ft. private balcony with sliding bay window

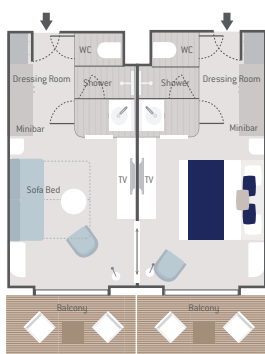

66 PRESTIGE STATEROOMS

19 sq.m. + 4 sq.m. private balcony with sliding bay window
204 sq.ft. + 43 sq.ft. private balcony with sliding bay window



5 DELUXE SUITES

27.5 sq.m. + 6 sq.m. private balcony with sliding bay window
291 sq.ft. + 65 sq.ft. private balcony with sliding bay window

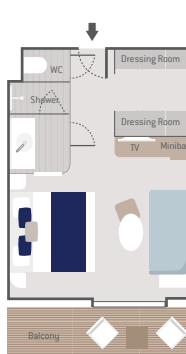

13 DELUXE STATEROOMS

19 sq.m. + 4 sq.m. private balcony with French window
204 sq.ft. + 43 sq.ft. private balcony with French window



Prestige stateroom



Deluxe suite

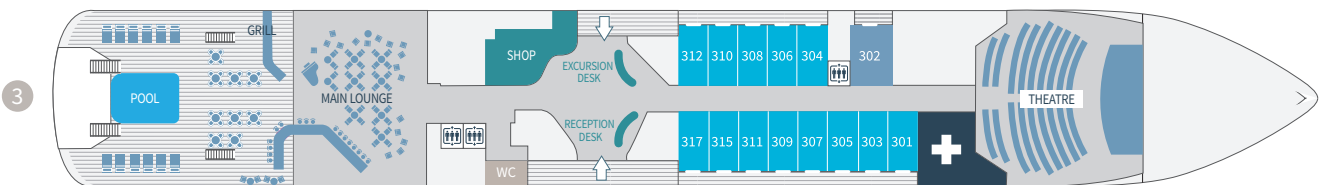
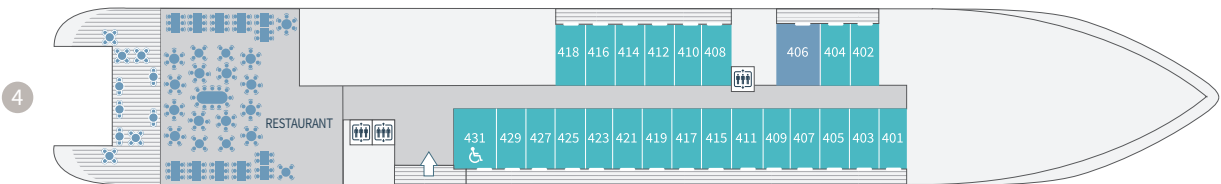
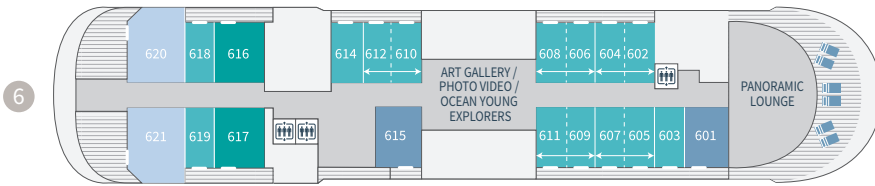
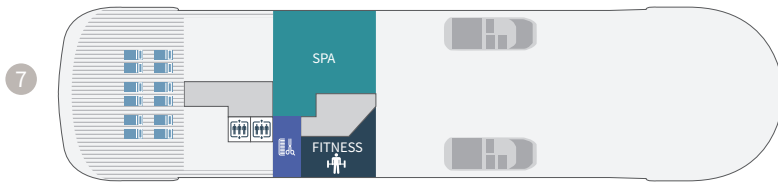

- | | | | |
|--------------------------------|-------------------------------|---------------------------------------|-----------------------------|
| Owner's Suites
Deck 5 | Grand Deluxe Suites
Deck 6 | Deluxe Suites
Deck 3 - 4 - 5 - 6 | Deluxe Staterooms
Deck 3 |
| Privilege Suites
Deck 5 - 6 | Prestige Suites
Deck 5 - 6 | Prestige Staterooms
Deck 4 - 5 - 6 | |



Amenities on board

Reception

- Open 24 hours a day

Guest Relations Desk

- Ask questions and receive information on PONANT and our voyages
- Book additional PONANT departures through the Travel Ambassador

Excursions Desk

- Review excursion options and make changes (if available)

Butler Service

- Provided for guests in the Owner's Suite, Deluxe Suite, Privilege Suite, and Prestige Suite located on Deck 6

Room Service

- Complimentary and available 24 hours a day

Wake-up Service

- A wake-up service is available, instructions are provided on board for guests

Laundry Service

- Price lists, laundry bags, and a laundry list can be found in each cabin
- 24–48 hours are required for the washing and ironing of clothing (dry cleaning is not available)

Stateroom Gifts

- In-stateroom gifts, including wine, pastries, and fruit can be arranged prior to boarding.

Gym

- Gym, open 24 hours a day
- A gentle gym class is occasionally offered in the mornings

Photography/Video Service

- A photographer and film maker are present aboard to capture every moment of the cruise
- A “Best-Of” CD of photos and a DVD are available for sale at the end of the cruise

Daily Program

- Published daily and delivered each evening to all cabins
- Contains the schedule for the next day's activities and information on the port of call

Bar

- Beer
- Cocktails
- Fruit juices, water, sodas, and tonics
- Wines
- Spirits
- Mini bar in each cabin, refilled daily

Postal Service

- Post can be sent from on board the ship by leaving it at reception (*the cost of the stamps will be added to the cabin account*)
- Stationary is provided in each cabin

Life On Board



STATEROOM AMENITIES

Each stateroom is equipped with a Nespresso machine, mini bar/mini fridge, safe, bathrobe, slippers, PONANT water bottle, Covid-19 kit, sparkling and still water, and vanity kit in the main space. Each stateroom bathroom includes a hairdryer, manicure kit, shampoo, conditioner, body wash, lotion, and shower cap. Space is available under the bed in your stateroom for multiple pieces of checked-bag sized luggage, in the closet, and in various drawers and shelves, depending on the size of the luggage.

SHIP KEY CARD

One key card will be given to each passenger upon embarkation. It is used to open your cabin, disembark and board the ship, and make purchases onboard. We kindly ask that you keep this card on you at all times.

ELECTRICAL POWER & OUTLETS

The electricity onboard is 220 volt AC (European standard), with 110 volt AC (North American standard) in stateroom bathrooms. We recommend guests

bring an adapter and a converter, though a limited number of adapters can be provided through the ship on a first-come, first serve basis and are available at Reception on our ships. For safety reasons, the use of personal irons and hair irons is not allowed.

LOUNGES

Enjoy refreshments, cocktails, and conversation in one of the inviting lounges: Panoramic Lounge, Main Lounge, Open-air Lounge.

THEATER

The perfect venue for presentations, lectures, and performances with state-of-the-art audio / visual technology and comfortable theater seating.

LIBRARY

The library area is a cozy spot for some quiet time with a book or magazine. It has an extensive selection to suit everyone's taste.

BOUTIQUE

The onboard signature shop, La Boutique, offers a range of clothing, souvenirs, gifts, jewelry, and toiletries. It is located on Deck 3 and is closed on Sundays and when the ship is docked in port.

BLUE EYE – UNDERWATER LOUNGE

Each PONANT Explorer ship is equipped with an underwater guest lounge, called Blue Eye, located within the hull beneath the water line. Two portholes shaped like the eye of a cetacean look out on the subaquatic world, while hydrophones integrated into the keel pipe the natural symphony of the seas into the lounge. Hours for Blue Eye are located on board the ship, at both the reception desk and in the forward elevator, as well as in the daily program. Please note that there are times when Blue Eye cannot be open for safety reasons.

DINING

Dining in any of our culinary venues on board our luxury yachts is an exquisite experience for the discriminating palate. In 2016, PONANT joined forces with Ducasse Conseil, a catering center of excellence run by Alain Ducasse Entreprise. From the conception of culinary offerings to the training of all the company's Chefs, this long-term project aims to ensure that PONANT's culinary standards are the highest possible and satisfy the exacting requirements of our international guests. Each of our restaurants has an open-seating policy to cater to guests' individual schedule on board. Our French chefs combine traditional gourmet cuisine with local specialties of the various ports we visit. Dine on fine cuisine in formal or casual restaurants (including alfresco options), with varying seating capacities, an array of seating options, and customizable menus.

DINING HOURS

Breakfast is available in Le Nautilus, our formal dining room, on Deck 4 from approximately 7:00 am – 9:00 am. Coffee and pastries are available in the Main Lounge from approximately 6:30 am – 10:00 am. Lunch is served in both Le Grill, our casual restaurant, on Deck 3 and Le Nautilus on Deck 4 from 12:00 pm – 2:00 pm, while dinner is served in both those restaurants from approximately 7:00 pm – 9:00 pm.

PRIVATE GROUP DINING

According to your group, function, or event needs, we can accommodate special occasions in our various restaurant venues on board, subject to availability and prior confirmation; these arrangements can be made in advance or once on board. Our chef is also able to accommodate special dietary needs and to enhance guests' dining experience with a customized menu

INCLUSIVE BEVERAGE PACKAGE

PONANT voyages include a broad selection of fine wine, champagne, beer, and liquor served throughout the cruise. Soft drinks, mineral water, and juice are also available. Beer, soft drinks, juice, tonic water and mineral water are available in each cabin's mini bar. There is an additional charge for premium wines and liquors. PONANT enjoys an exclusive partnership with the French champagne house Veuve Clicquot and is proud to serve the renowned label's spirits aboard all yachts. *Alcohol service may be restricted in some countries.*

LAUNDRY

Laundry service is available on board all our ships for a fee. Price lists and laundry bags can be found in each cabin. Washing and ironing of clothing takes 24 to 48 hours. Dry cleaning and self-service laundry is not available.

PHOTOGRAPHY / VIDEO SERVICE

Photos and videos taken by our onboard team are available for viewing on Deck 6 in the Art/Photo/Video gallery. If you would like to purchase a photo or video, this must be done prior to departure day, as photos and videos are not available after the cruise ends.

POSTAL SERVICE

If you use this included service, please note that there may be delays in delivery to your intended recipient and anything time sensitive should not be mailed.

ZOADIC FLEET

The ships are equipped with a fleet of Zodiac boats which comfortably transport guests to shore and allow for exceptional discoveries of wildlife and the surrounding coastal landscapes. This is an absolute must for exploratory excursions along coastlines or for

accessing shallow water ports. Zodiacs are safe, nimble, stable, durable, and easy to board. Our highly-trained crew operates and maintains them. Zodiac launches are conducted from the stern via our marine platform, which is more stable than launching from the sides of the ship.

LANGUAGE

All announcements, signage and communications are in English and French. Staff and crew all speak English and French.

PAYMENT ON BOARD

An account is opened at Reception for each stateroom. (It is possible to have separate accounts for each guest.) We ask guests to leave an imprint of their credit card at Reception. Any onboard spending (boutique, spa, laundry, excursions, etc.) is automatically added to the account. A detailed invoice and credit card receipt are placed in the stateroom the night before guests disembark the ship. Onboard accounts are closed for billing on the last night of each cruise. From 10:00 pm that evening all payments must be made in cash. The currency aboard is the Euro, but the US dollar is also accepted. Approved payment methods include: credit card (Visa, American Express, MasterCard); cash; and travelers' checks. It is not possible to exchange currency on board our ships. We advise you to exchange currency either through your bank or at the airport upon arrival. You can also use an ATM when we arrive in port, depending on location.

COMPLIMENTARY WIFI

WiFi access is available throughout the ship, in staterooms and public areas. Please Note: There will be times when the ship will be out of satellite range. When there is satellite signal available, the bandwidth will be relatively narrow and speed will be correspondingly slow. It is not the fast internet you have likely become accustomed to at work and at home. You will be able to send and receive email messages and check your personal email accounts without difficulty, but we do not recommend 'surfing' the web, downloading files of any significant size, or attempting to stream audio or video.

TELEPHONE

A satellite communication system is available for guests to use at the rate of €6/minute.

GRATUITIES

Gratuities are included in your cruise fare. Additional tips to staff, crew, and spa therapists are at the discretion of the guest.

DRONES

The use of drones about PONANT ships, whether they are sailing at sea, at a port of call, or anchored, is strictly forbidden.

HEALTH/MEDICAL

The ship's infirmary is available 24 hours a day and is equipped to treat non-emergency matters. A doctor is available on board every ship, and accompanies guests on off-ship excursions. There is a fee for consultations and medical procedures carried out on board. These are not covered by health insurance plans or Social Security. Please note, onboard physicians cannot fill prescriptions; please be sure to bring all necessary medications with you.

ACCESSIBILITY

PONANT Explorer Ships are fully ADA compliant, with accessible staterooms, elevators and lifts for stairs for easy access to all decks and public areas.

SMOKING / NON-SMOKING

All enclosed areas (lounge areas, dining room, staterooms, reception area, etc.) are non-smoking. Smoking is not permitted on balconies. Smoking is allowed in the ship's designated outdoor areas.

LIFEBOAT DRILL

A lifeboat drill will be conducted before the ship leaves the embarkation port. A life jacket to use during the lifeboat drill can be found in your cabin closet. You will be shown how to use your life jacket during the drill. It is mandatory that all travelers participate in the lifeboat drill.

Spa and fitness



A journey at sea is the ideal time to indulge oneself with an array of spa and fitness services that will relax and rejuvenate the body, mind, and spirit. Guests can enjoy a soothing massage, swim in the outdoor pool, or soak in the warmth of the sun on the open deck space with views out to sea—all a wonderful complement to a day of activity spent in meetings or on excursions ashore.

PONANT's spa offers a range of luxurious services featuring products by Sothys, the leading French beauty and skincare line. Expert beauticians and massage therapists pamper guests with personalized facial and body treatments suited to their unique, individual needs. Choose from massages, facials, body scrubs, anti-aging treatments, and other options. Spa appointments cannot be made in advance; they can only be made once on board.

OUR FITNESS AND BEAUTY FACILITIES INCLUDE:

- Two treatment rooms
- Steam room
- Hairdresser
- Herbal tea bar
- Semi-private outdoor relaxation area
- A fitness space with a panoramic sea view, outfitted with a Kinesis wall, treadmills, stationary bikes, and other equipment
- Outdoor swimming pool and sun deck